



® Knowledge Beyond Measure.

# TSI® OmniTrak™ Solution

## Sound Level Meter Class 2 Module



### **Efficiency Meets Intelligence. Customizable, Scalable, and Affordable Monitoring.**

The TSI OmniTrak™ Solution is a customizable, scalable, and affordable solution enabled by connecting innovative monitoring instruments, intelligent software and service solutions. This solution allows you to plan, measure, report, recommend, and monitor key risks to help improve health, wellbeing, and efficiency. The OmniTrak™ Sound Level Meter (SLM) module is ideal for workplace noise measurement and reporting.

#### **Features and Benefits**

- Measurement range to 143dB (peak)
- Compliant with IEC 61672 and ANSI S1.4 Sound Level Meter Standards – Class 2
- Simple operation with defined (e.g. OSHA, ISO etc) and configurable setups
- Remote operation of sound module and Smart Station (in Bluetooth® range)
- Measures all relevant workplace noise parameters
- Long battery life – 14 hours, with USB C charging
- High resolution touch screen operation (via Smart Station)
- Automatic calibration function
- Modular design allowing other sensor modules to be connected to the Smart Station
- Download data directly from the Smart Station to your PC or upload data to our TSI Link™ Software Solution platform to manage and view data remotely.

#### **Applications**

- Occupational noise measurements
- Selection of hearing protection
- Calculation of noise exposure
- Workplace spatial mapping

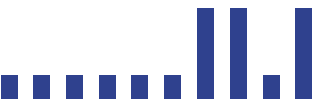

# TSI® OmniTrak™ Solution Sound Level Meter Class 2 Module

## Quick Setup

Using the large touch screen, setup of sound level measurements can be completed quickly to save time.

- Default setups are available for key workplace standards (OSHA HC, OSHA PEL, ACGIH and ISO).
- Custom setups can also be made with a combination of parameters as needed. These can be named and stored for future recall.
- Key parameters displayed are instantaneous noise, average, peak, and 8-hour exposure.

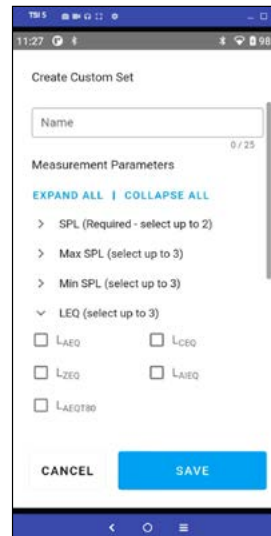

## Calibration for Confidence in Results

The OmniTrak™ Sound Level Meter (SLM) module can be supplied with an acoustic calibrator, measurements can be field calibrated at 114.0dB. Once the calibrator is applied, calibration is automatic to the prescribed level giving confidence and traceability of results.

- Stores calibration level, time and date
- Automatic calibration detection
- Post calibration drift calculated, stored and available in downloaded reports

OmniTrak™ SLM module is supplied with calibration certificates to comply with ANSI and IEC standards.

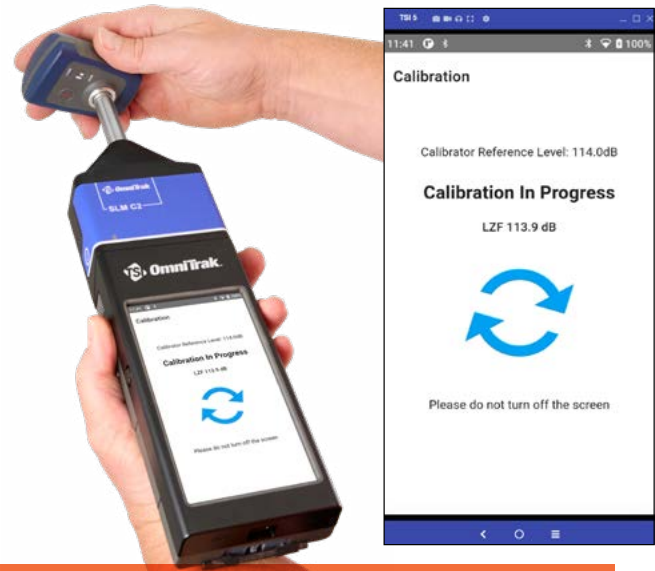

## Comprehensive, Clear Measurements

The user interface is designed to make comprehensive measurements as quickly and easily as possible.

Measurements can be done individually or combined together in 'studies'. All measurements are date and time stamped and can be paused and resumed as needed.

With the large backlight screen, it can be viewed in all conditions. The parameters on the screen can be customised as needed, and even moved around the screen.

Data can be viewed in numeric or graphical form to see the time history variations. Notes can then be added to annotate significant events.



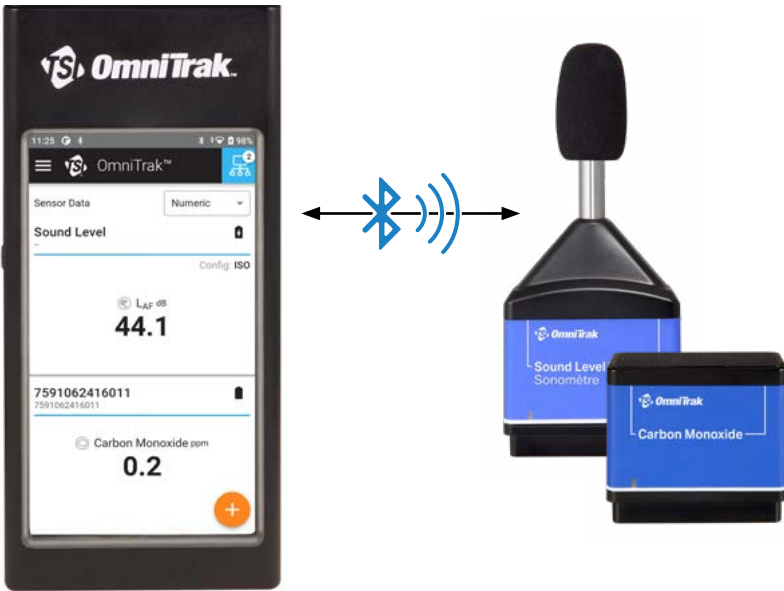

## Workplace Studies with a Wide Range of Sensors

TSI® OmniTrak™ Solution is not just for measuring workplace noise, other modules can be purchased for assessing workplace hazards.

Modules include sensors for: Particulate (PM10, PM4, PM2.5, PM1), Volatile Organic Compounds (VOCs) and various gases.

Multiple modules can be connected remotely through Bluetooth®, so surveys of multiple risks can be completed at the same time.



## Create Reports with Ease

The TSI Link™ Report Creator automatically imports and aggregates your data generating quick custom reports in Excel®.

Allowing access to Excel® templates for your study, including graphs and smart visualizations, and to save time simplifying data analysis and reporting.

CSV files can be uploaded from the OmniTrak™ Smart Station easily through USB-C connection or via WiFi connection to the report creator.

Through Excel® templates are included to create reports and manage data in various ways needed to report noise measurements.



## TSI Link™ Report Creator

TSI Link™ Report Creator Solution software subscription. The Report Creator automatically imports and aggregates your data generating quick custom reports in Excel®.

- Seamless cloud data connection with TSI OmniTrak™ Solution and all DustTrak™ Monitors, through TSI Link™ Smart Bridge
- Automated custom reports in Excel® in few clicks
- Smart data visualization through the Layout View
- Support upload of CSV files to generate reporting
- One-stop reporting solution for multiple devices and analysis needs

## Specifications

# TSI® OmniTrak™ Solution Sound Level Meter Class 2 Module

### Technical Specification

#### Dynamic Range

40-140dB RMS, 143.3dB Peak

#### Noise Floor

<31dB(A)

#### Memory

32GB in Smart Station

#### Calibration

Via optional 7590-80 calibrator. Stores pre and post run date, time and level

#### Output

USB C

#### Battery Life

Module: 14 hours,  
Smart Station: 14 hours (Max brightness)

#### Charging

Via USB C (cable supplied)

#### Frequency weightings RMS

Simultaneous A, C & Linear (Z)

#### Frequency weightings Peak

Simultaneous A, C & Linear (Z)

#### Time weightings

Simultaneous Slow, Fast & Impulse  
Amplitude weightings: Q3, Q4 and Q5

#### Thresholds

70 to 90 (dB) in 1 dB step

#### Applicable Standards

##### Sound Level Meter

IEC61672-1, ANSI S1.4. Class2

#### Temp Range

Operation: 0 - 40C  
Storage: -10 - 50C

Specifications are subject to change without notice.

The Bluetooth® word mark and logos are registered trademarks owned by Bluetooth SIG, Inc. and any use of such marks by TSI Incorporated is under license. Other trademarks and trade names are those of their respective owners.

Excel® is a registered trademark of Microsoft Corporation in the United States and/or other countries.

TSI, the TSI logo are registered trademarks of TSI Incorporated in the United States and may be protected under other country's trademark registrations.

#### Dimensions

Module: H 170mm, W 85mm, D 35mm  
SmartStation: H 175mm, W 85mm, D 35mm

#### Weight

Module: 220g (7.7oz)  
SmartStation: 360g (12.7oz)

#### Measured Parameters and Setups

LXY, LXYmax, LXYmin, LXeq, LXpeak, Lavg, LC-LA, LXleq, LTM3, LTM5, LAE. Where X is the frequency weighting A, C or Z and Y represents time weighting Fast (F), Slow (S) or Impulse (I). All weightings simultaneously measured where appropriate.

8 hour dose values: LAep,d, TWA, % Dose. Projected work time can be inputted to calculate projected exposure.

#### OmniTrak™ Cases Available

OmniTrak™ SLM can be ordered with a robust carry case to hold relevant accessories.



#### To Order

##### Specify

7591-09

##### Description

Sound Level Meter Module  
– Class 2-Includes module, microphone, windshield, field guide, calibration certificate and USB-C cable  
7590-00  
7590-80  
OmniTrak Smart Station  
Class 2 Acoustic Calibrator - Includes calibration certificate and field guide

##### Accessories

7590-11

Single Case – for 1 Sound Level Meter module, or 2 Omnitrak Modules and SmartStation  
7590-21  
Triple Case – for 3 Sound Level Meter Modules, or 6 Omnitrak Modules and SmartStation

##### Parts

7590-81

Windshield

7590-82

Class2 Microphone



Knowledge Beyond Measure.

TSI Incorporated - Visit our website [www.tsi.com](http://www.tsi.com) for more information.

<b>USA</b>	Tel: +1 800 874 2811	<b>India</b>	Tel: +91 80 67877200
<b>UK</b>	Tel: +44 149 4 459200	<b>China</b>	Tel: +86 10 8219 7688
<b>France</b>	Tel: +33 1 41 19 21 99	<b>Singapore</b>	Tel: +65 6595 6388
<b>Germany</b>	Tel: +49 241 523030		

For ordering other modules for OmniTrak please visit [www.tsi.com](http://www.tsi.com)



Distributed by:

Kenelec Scientific Pty Ltd  
1300 73 22 33  
[sales@kenelec.com.au](mailto:sales@kenelec.com.au)  
[www.kenelec.com.au](http://www.kenelec.com.au)